

## Table of Contents

Title	Number
IKOTherm Fastening Pattern 4'x4' Board, 4 Fasteners	F-1
IKOTherm Fastening Pattern 4'x4' Board, 5 Fasteners	F-2
IKOTherm Fastening Pattern 4'x4' Board, 6 Fasteners	F-3
IKOTherm Fastening Pattern 4'x4' Board, 8 Fasteners	F-4
IKOTherm Fastening Pattern 4'x4' Board, 9 Fasteners	F-5
IKOTherm Fastening Pattern 4'x4' Board, 11 Fasteners	F-6
IKOTherm Fastening Pattern 4'x4' Board, 12 Fasteners	F-7
IKOTherm Fastening Pattern 4'x4' Board, 14 Fasteners	F-8
IKOTherm Fastening Pattern 4'x4' Board, 16 Fasteners	F-9
ProtectoBoard Fastening Pattern – 4'x5' Board, 5 Fasteners	F-10
ProtectoBoard Fastening Pattern – 4'x5' Board, 9 Fasteners	F-11
IKOTherm Fastening Pattern - 4'x8' Board, 8 Fasteners	F-12
IKOTherm Fastening Pattern - 4'x8' Board, 8 Fasteners	F-12 A
IKOTherm Fastening Pattern - 4'x8' Board, 10 Fasteners	F-13
IKOTherm Fastening Pattern - 4'x8' Board, 12 Fasteners	F-14
IKOTherm Fastening Pattern - 4'x8' Board, 15 Fasteners	F-15
IKOTherm Fastening Pattern - 4'x8' Board, 16 Fasteners	F-16
IKOTherm Fastening Pattern - 4'x8' Board, 24 Fasteners	F-17
IKOTherm Fastening Pattern - 4'x8' Board, 32 Fasteners	F-18
ShieldBase and Protectobase Fastening Pattern - 18" O.C. Fasteners	F-19
ShieldBase and Protectobase Fastening Pattern - 12" O.C Fasteners	F-20
ShieldBase and Protectobase Fastening Pattern - 6" O.C Fasteners	F-21
ShieldBase and Protectobase 12" O.C Mid Seam and In-Row	F-22
Protectobase at Parapet Detail	F-23
Pre-Securement Pattern for Insulation under Mechanically Fastened Membrane System, 4'x4' Board	F-24
Pre-Securement Pattern for Insulation under Mechanically Fastened Membrane System, 4'x8' Board	F-25
Fastening Pattern for Mechanical Attachment of Base Sheet Fast-N-Weld	FNW-1 – FNW-8

## IKOTHERM™ Fastening Pattern 4'X4' Board, 4 Fasteners

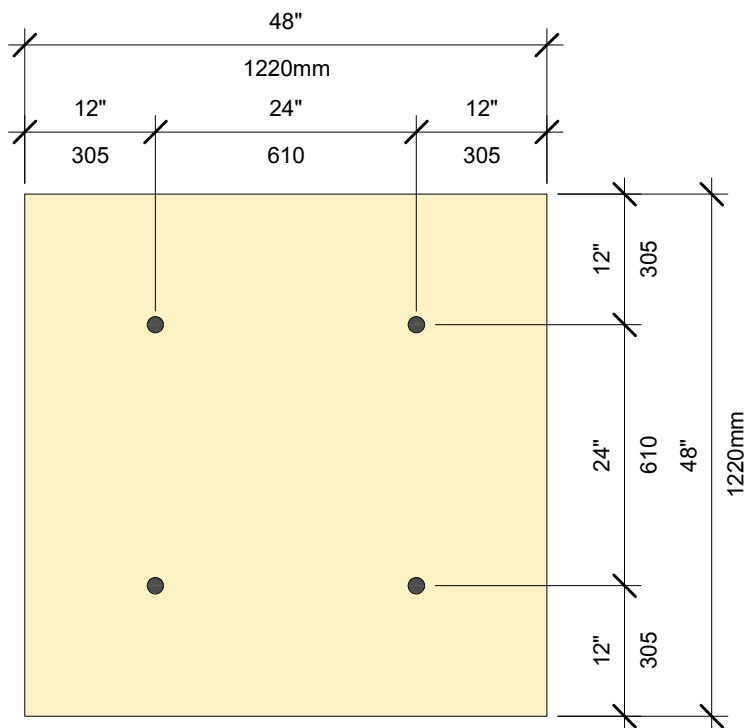

### NOTES:

1. Applies to 2" thickness and above.
2. Specific CSA or FM test results may modify this diagram.
3. This fastening pattern may be used for any 4' x 4' board products within an approved IKO roofing system.



**IKOTHERM™ Fastening Pattern 4'X4' Board, 5 Fasteners**

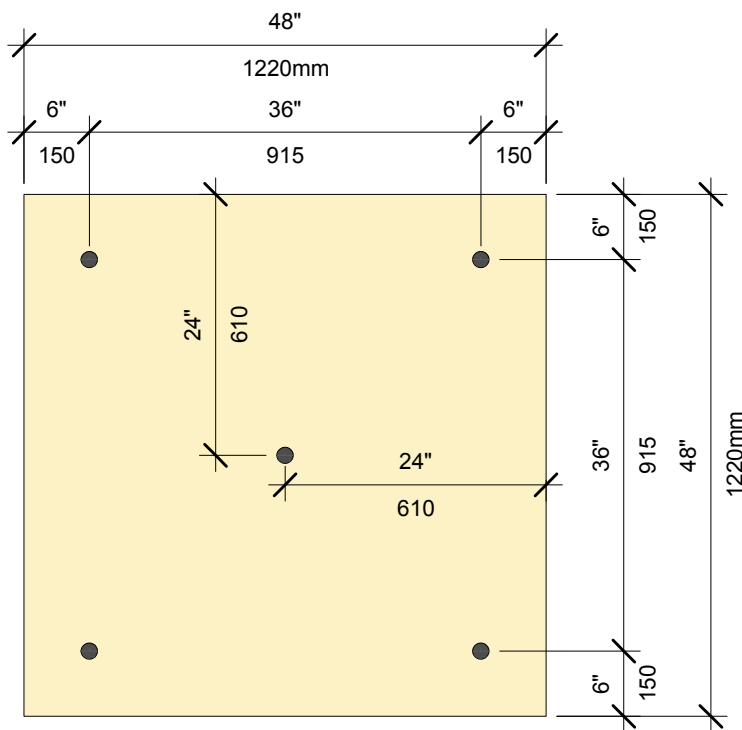

**NOTES:**

1. Applies to 2" thickness and above.
2. Specific CSA or FM test results may modify this diagram.
3. This fastening pattern may be used for any 4' x 4' board products within an approved IKO roofing system.

## IKOTHERM™ Fastening Pattern 4'X4' Board, 6 Fasteners

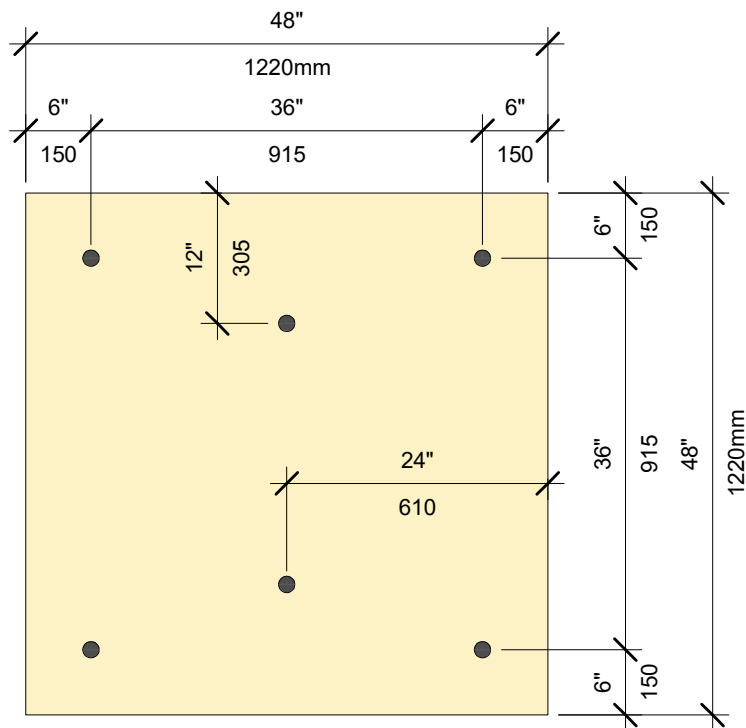

### NOTES:

1. Applies to 1.5" thickness and above.
2. Specific CSA or FM test results may modify this diagram.
3. This fastening pattern may be used for any 4' x 4' board products within an approved IKO roofing system.



**IKOTHERM™ Fastening Pattern 4'X4' Board, 8 Fasteners**

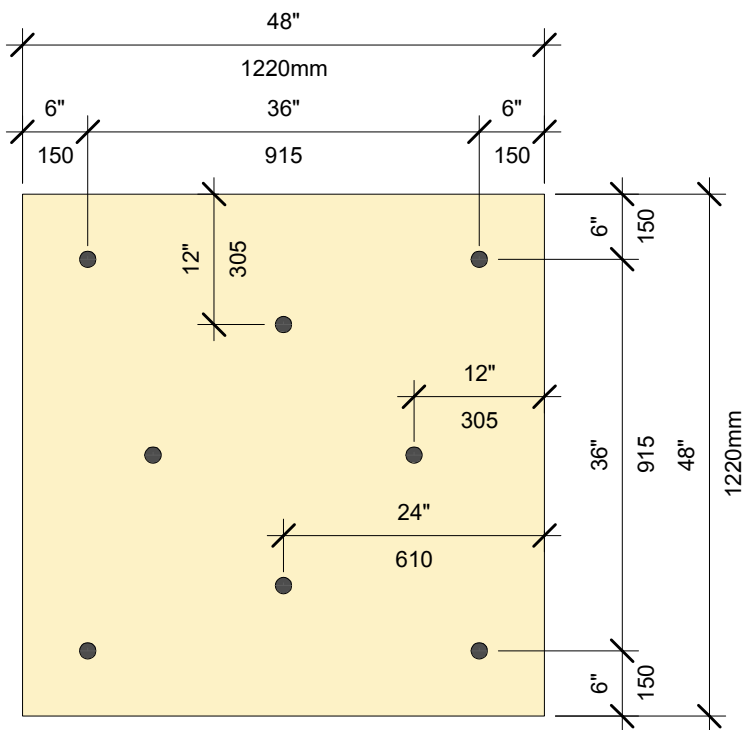

**NOTES:**

- 1. Applies to 1.5" thickness and above.
- 2. Specific CSA or FM test results may modify this diagram.
- 3. This fastening pattern may be used for any 4' x 4' board products within an approved IKO roofing system.

**IKOTHERM™ Fastening Pattern 4'X4' Board, 9 Fasteners**

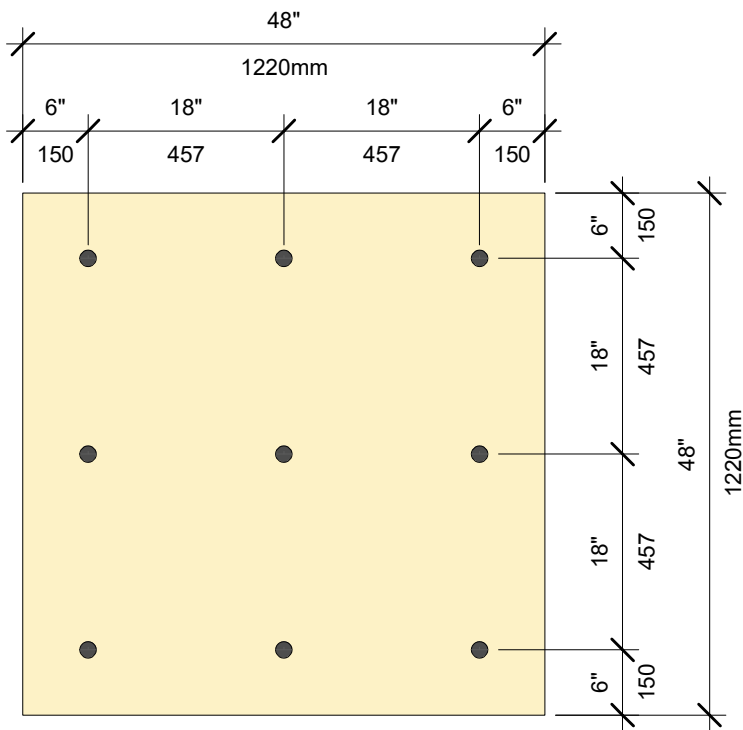

**NOTES:**

1. Applies to 1.5" thickness and above.
2. Specific CSA or FM test results may modify this diagram.
3. This fastening pattern may be used for any 4' x 4' board products within an approved IKO roofing system.



**IKOTHERM™ Fastening Pattern 4'X4' Board, 11 Fasteners**

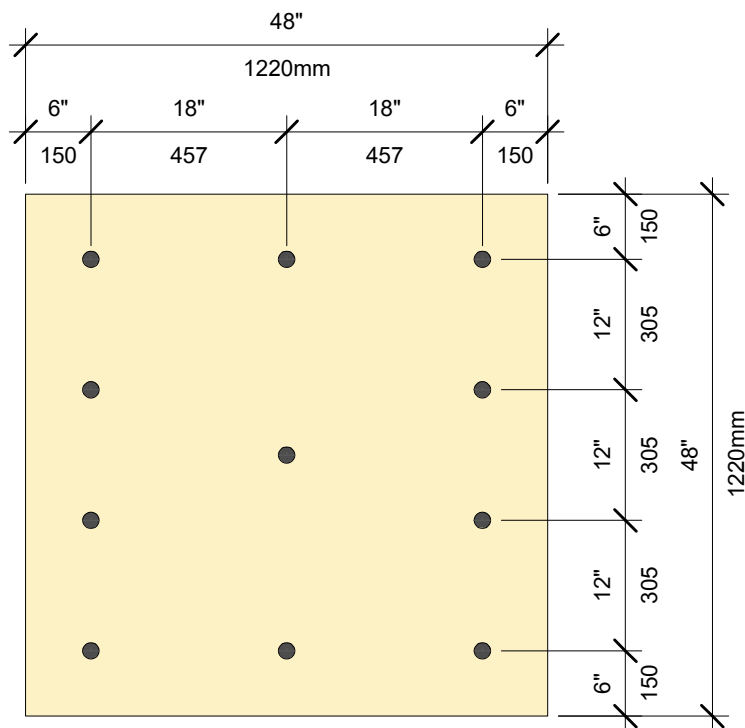

**NOTES:**

1. Applies to 1.5" thickness and above.
2. Specific CSA or FM test results may modify this diagram.
3. This fastening pattern may be used for any 4' x 4' board products within an approved IKO roofing system.

**IKOTHERM™ Fastening Pattern 4'X4' Board, 12 Fasteners**

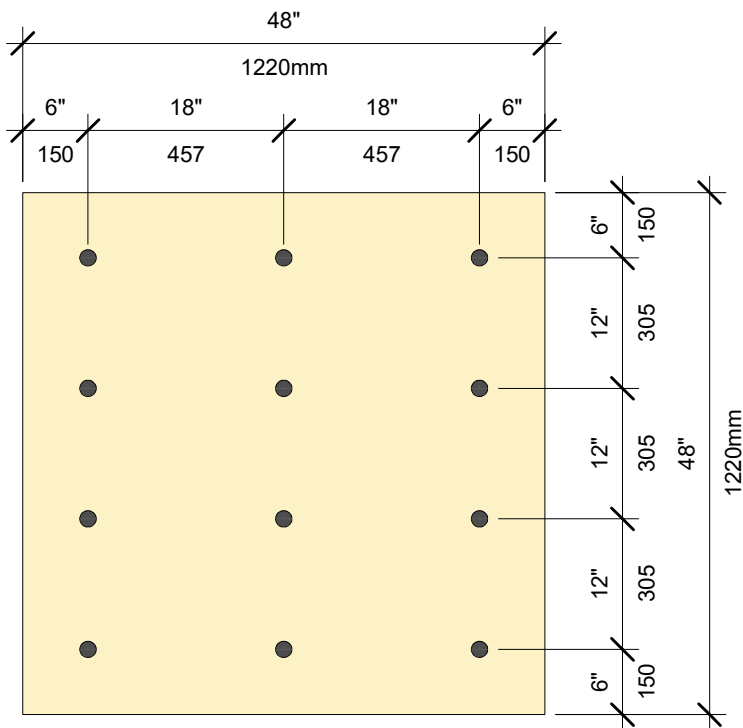

**NOTES:**

1. Applies to 1.5" thickness and above.
2. Specific CSA or FM test results may modify this diagram.
3. This fastening pattern may be used for any 4' x 4' board products within an approved IKO roofing system.





**IKOTHERM™ Fastening Pattern 4'X4' Board, 14 Fasteners**

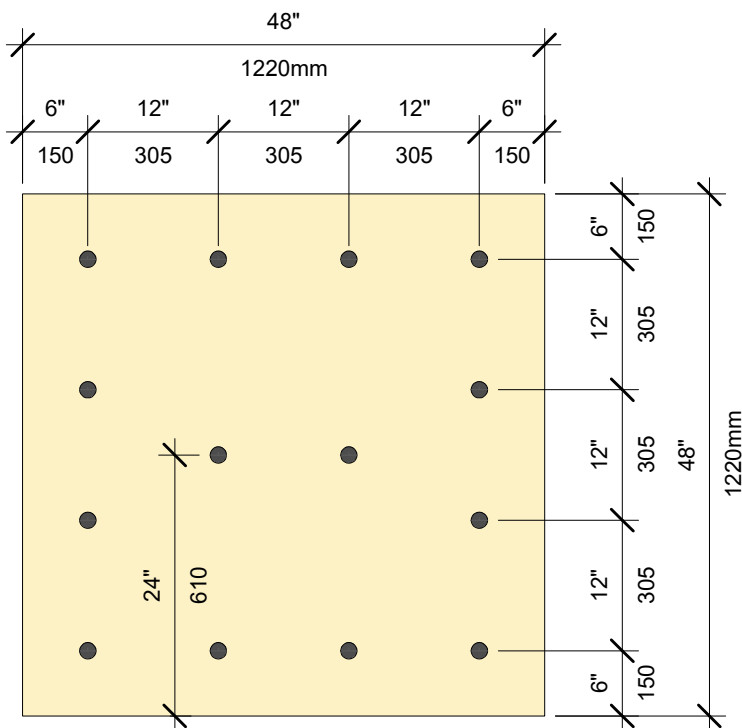

**NOTES:**

1. Applies to 1.5" thickness and above.
2. Specific CSA or FM test results may modify this diagram.
3. This fastening pattern may be used for any 4' x 4' board products within an approved IKO roofing system.

**IKOTHERM™ Fastening Pattern 4'X4' Board, 16 Fasteners**

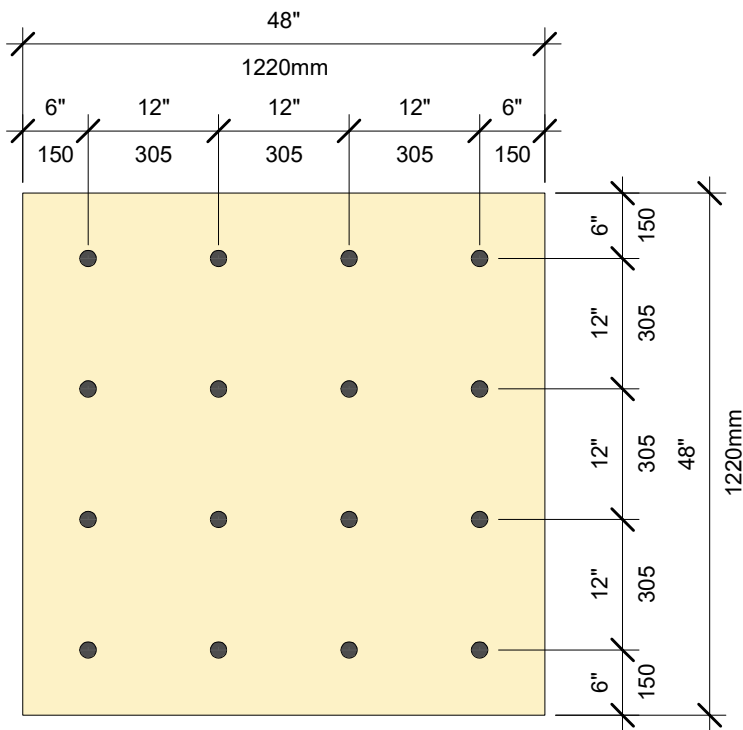

**NOTES:**

1. Applies to 1.5" thickness and above.
2. Specific CSA or FM test results may modify this diagram.
3. This fastening pattern may be used for any 4' x 4' board products within an approved IKO roofing system.

**PROTECTOBOARD™ Fastening Pattern 4'X5' Board, 5 Fasteners**

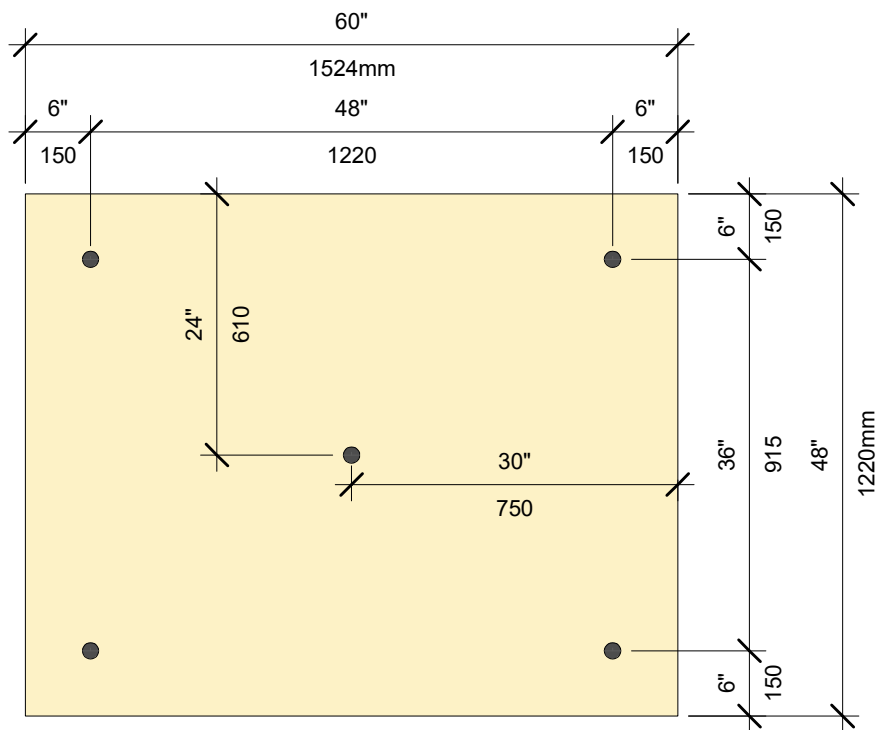

**NOTES:**

1. Applies to 1/8" thickness and above.
2. Specific CSA or FM test results may modify this diagram.
3. This fastening pattern may be used for any 4' x 5' board products within an approved IKO roofing system.

**PROTECTOBOARD™ Fastening Pattern 4'X5' Board,  
9 Fasteners**

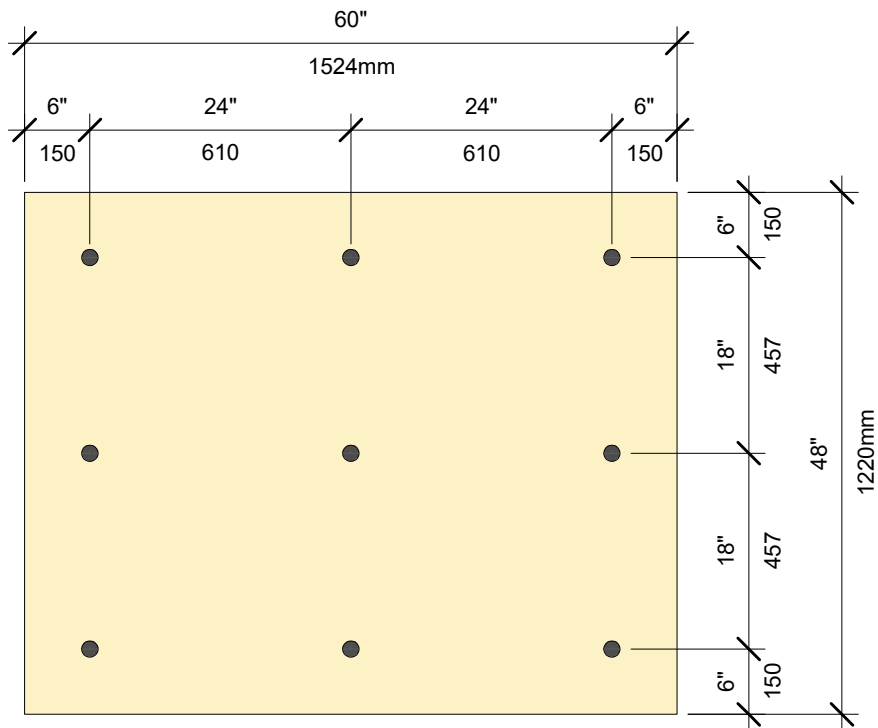

**NOTES:**

1. Applies to 1/8" thickness and above.
2. Specific CSA or FM test results may modify this diagram.
3. This fastening pattern may be used for any 4' x 5' board products within an approved IKO roofing system.



**IKOTHERM™ Fastening Pattern 4'X8' Board, 8 Fasteners**

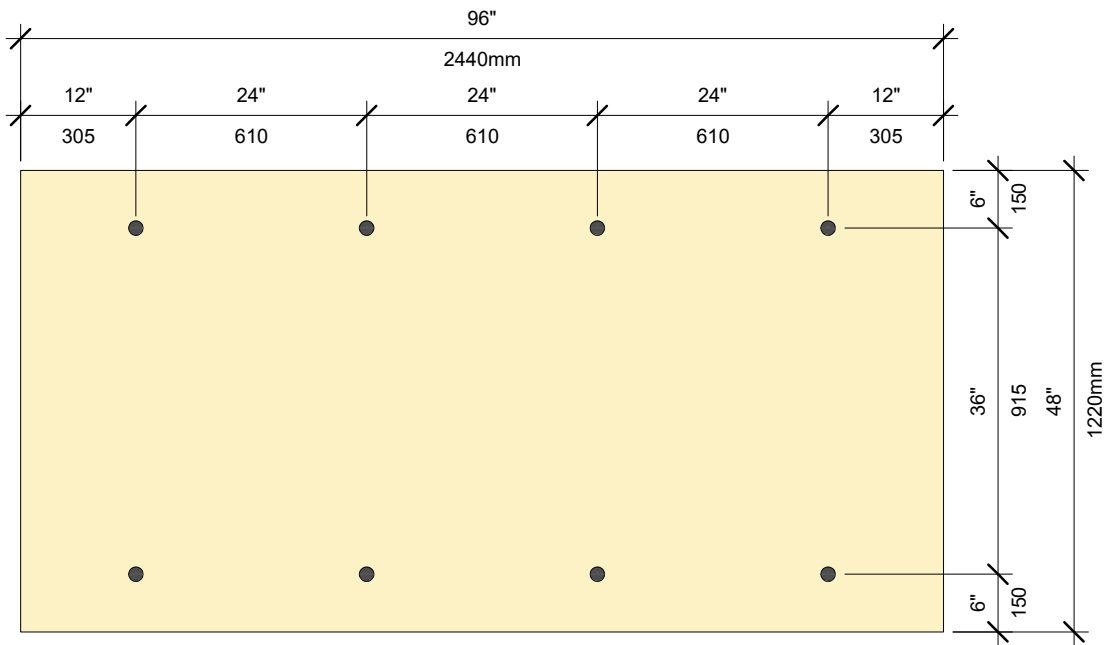

**NOTES:**

1. Applies to 2" thickness and above.
2. Specific CSA or FM test results may modify this diagram.
3. This fastening pattern may be used for any 4' x 8' board products within an approved IKO roofing system.

## IKOTHERM™ Fastening Pattern 4'X8' Board, 8 Fasteners

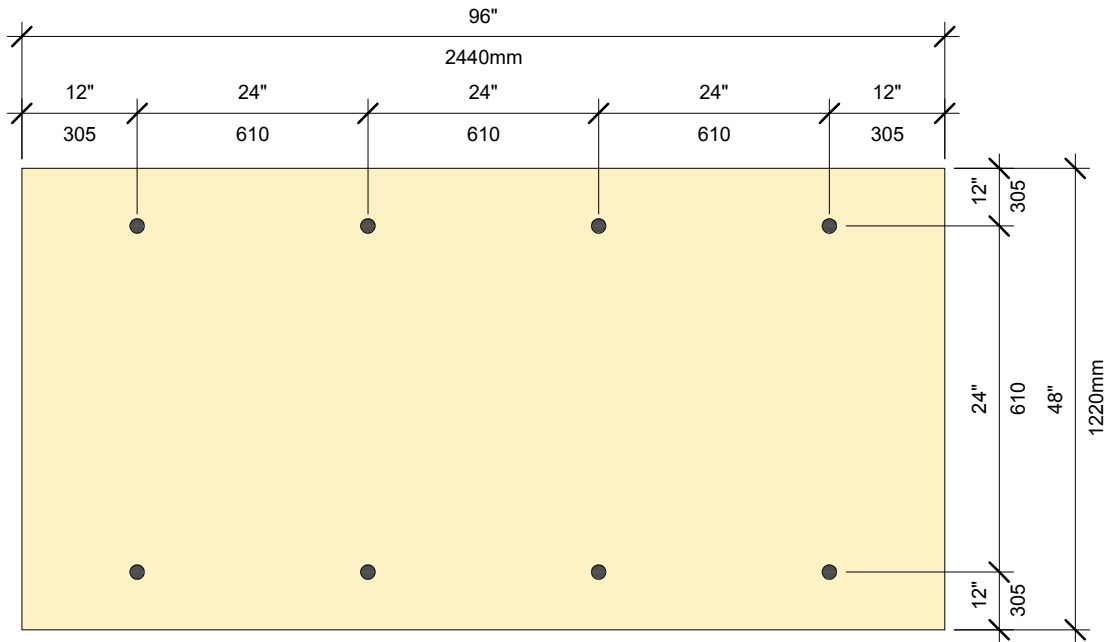
**NOTES:**

1. Applies to 1/8" thickness and above.
2. Specific CSA or FM test results may modify this diagram.
3. This fastening pattern may be used for any 4' x 8' board products within an approved IKO roofing system.



**IKOTHERM™ Fastening Pattern 4'X8' Board, 10 Fasteners**

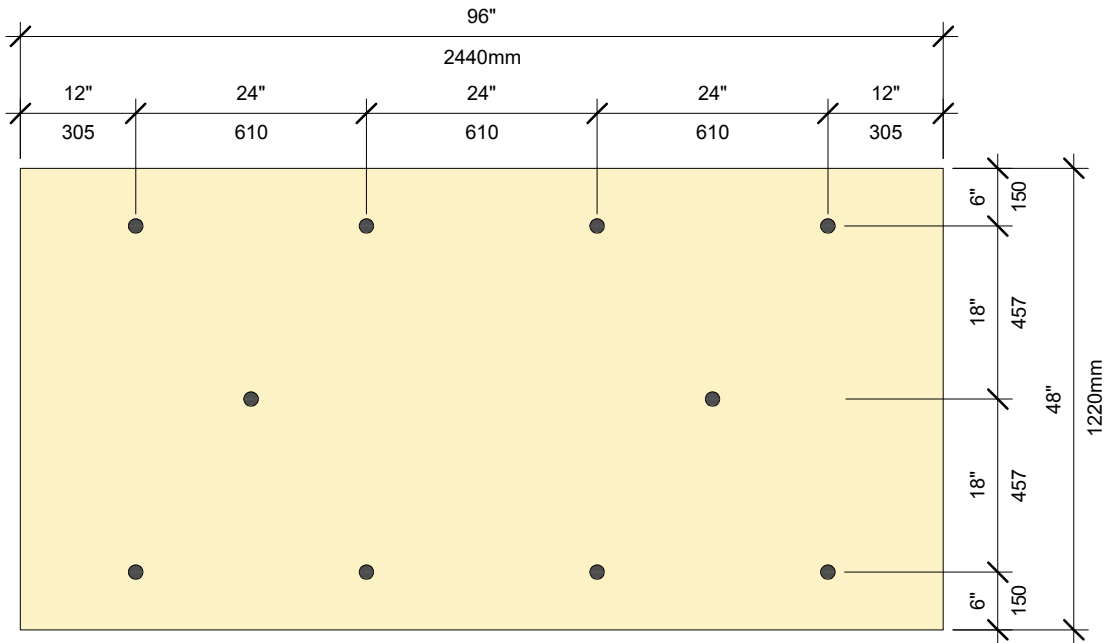

**NOTES:**

1. Applies to 2" thickness and above.
2. Specific CSA or FM test results may modify this diagram.
3. This fastening pattern may be used for any 4' x 8' board products within an approved IKO roofing system.

**IKOTHERM™ Fastening Pattern 4'X8' Board, 12 Fasteners**

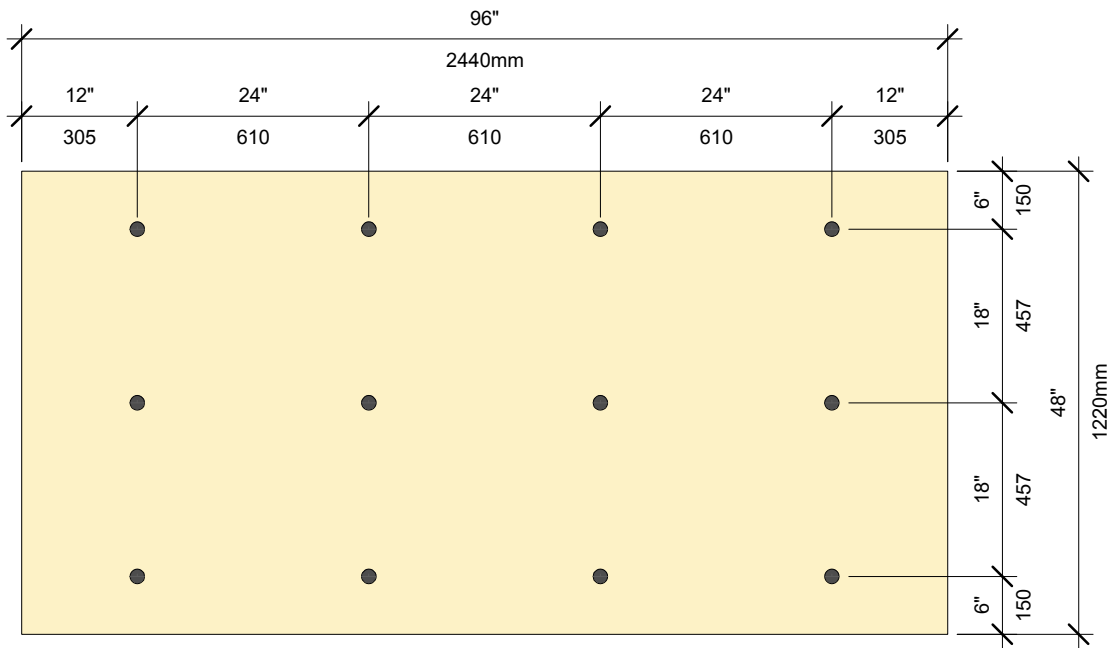

**NOTES:**

1. Applies to 1.5" thickness and above.
2. Specific CSA or FM test results may modify this diagram.
3. This fastening pattern may be used for any 4' x 8' board products within an approved IKO roofing system.





**IKOTHERM™ Fastening Pattern 4'X8' Board, 15 Fasteners**

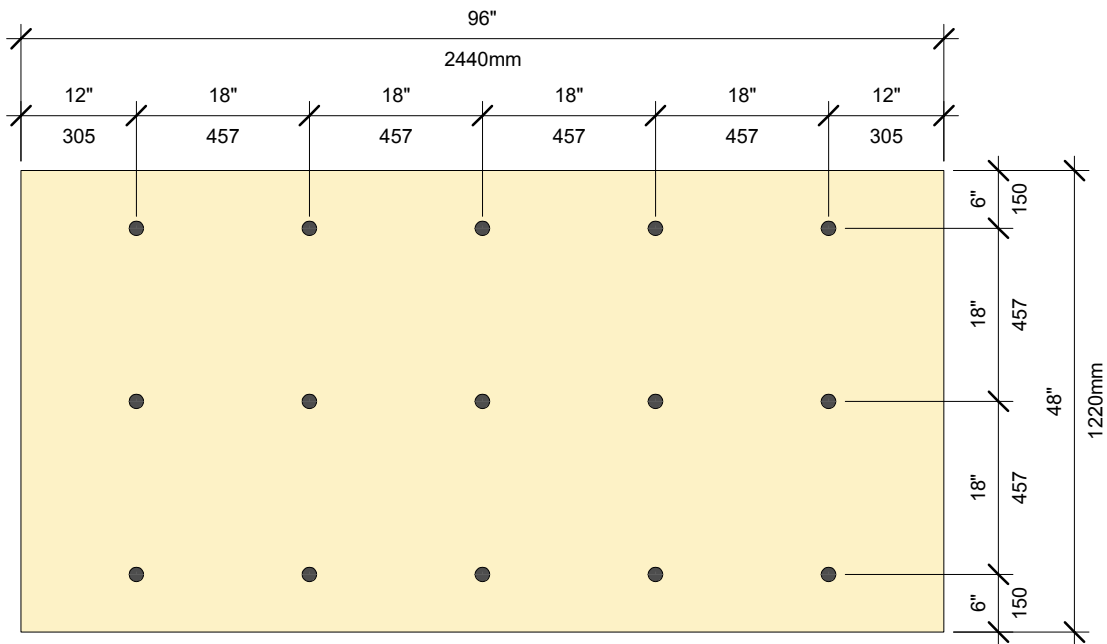

**NOTES:**

1. Applies to 1.5" thickness and above.
2. Specific CSA or FM test results may modify this diagram.
3. This fastening pattern may be used for any 4' x 8' board products within an approved IKO roofing system.

**IKOTHERM™ Fastening Pattern 4'X8' Board, 16 Fasteners**

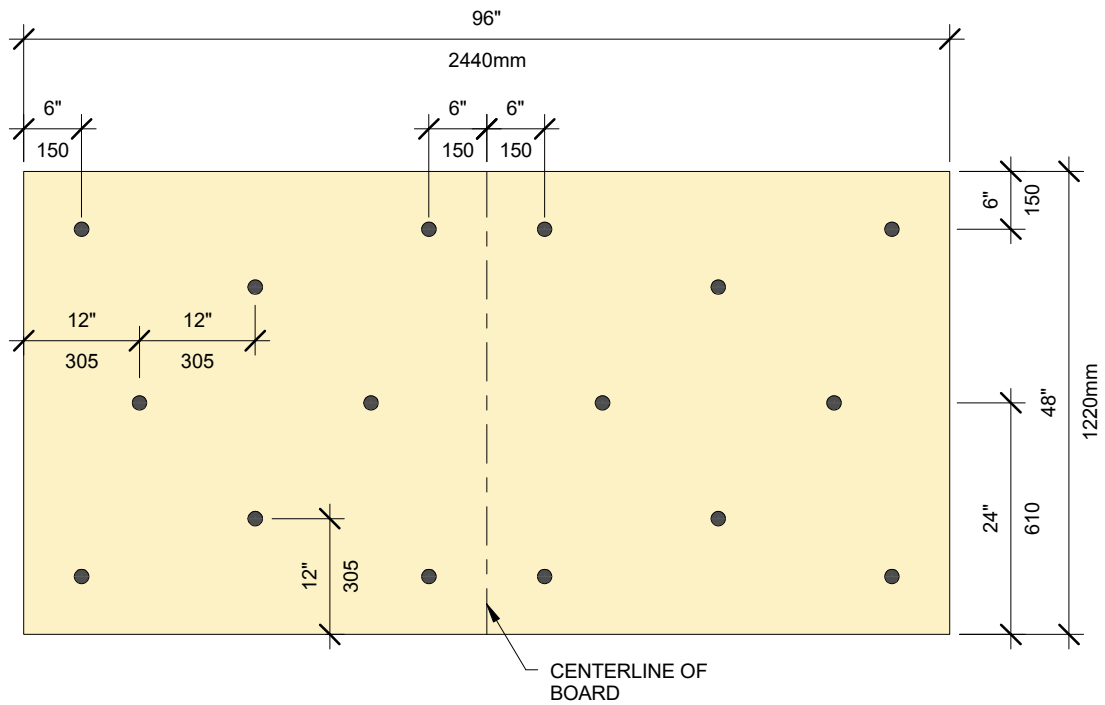

**NOTES:**

1. Applies to 1.5" thickness and above.
2. Specific CSA or FM test results may modify this diagram.
3. This fastening pattern may be used for any 4' x 8' board products within an approved IKO roofing system.



**IKOTHERM™ Fastening Pattern 4'X8' Board, 24 Fasteners**

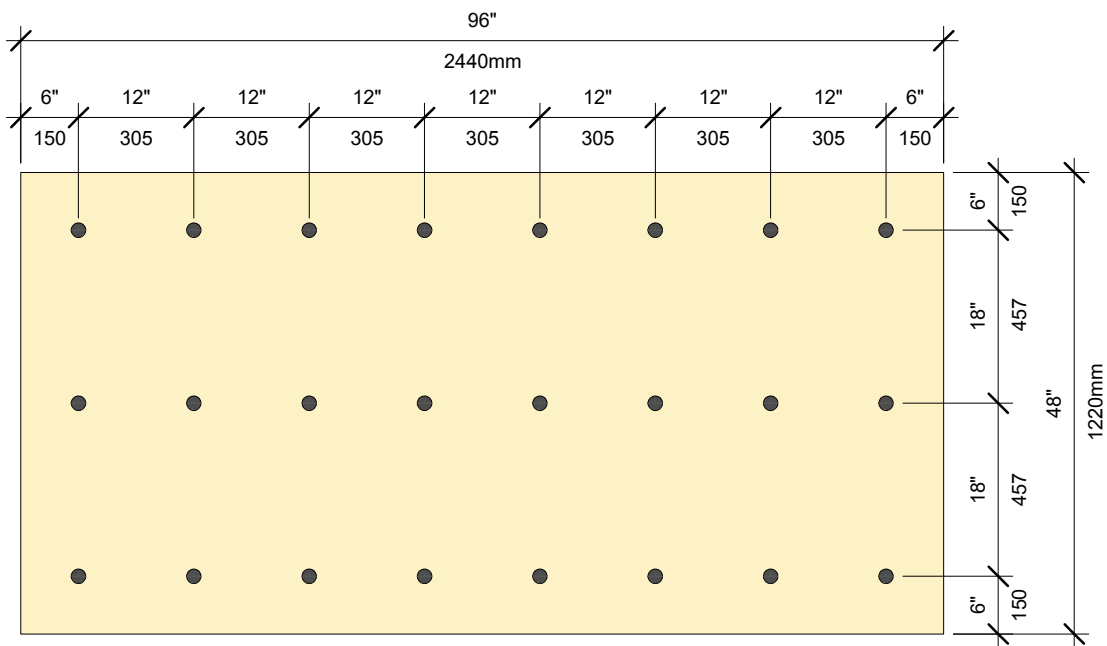

**NOTES:**

1. Applies to 1.5" thickness and above.
2. Specific CSA or FM test results may modify this diagram.
3. This fastening pattern may be used for any 4' x 8' board products within an approved IKO roofing system.

**IKOTHERM™ Fastening Pattern 4'X8' Board, 32 Fasteners**

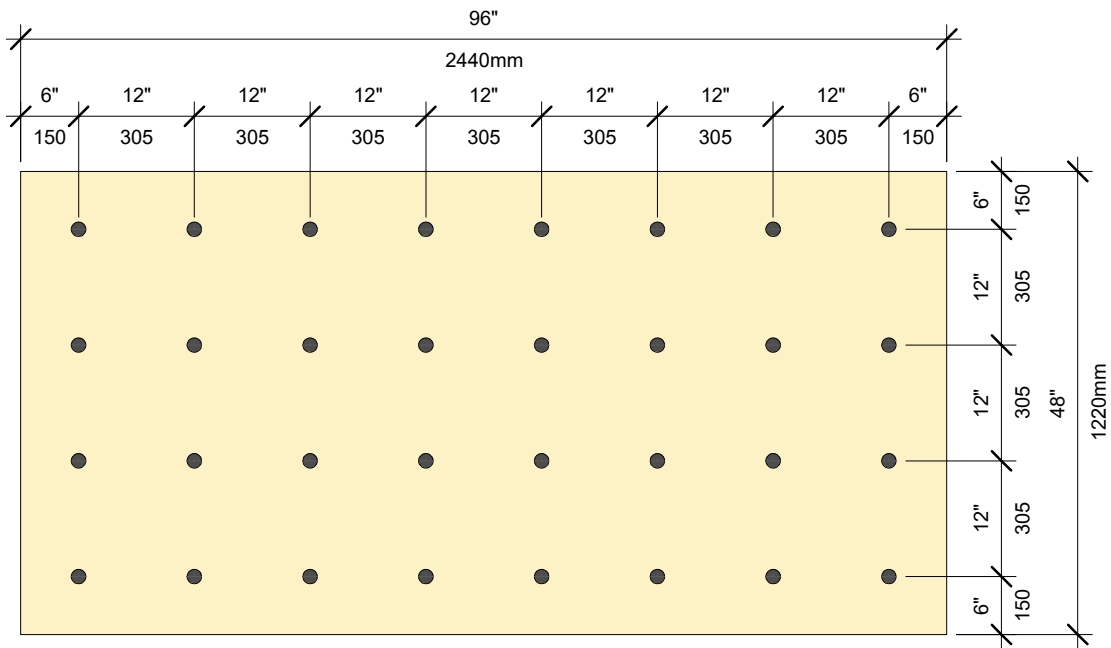

**NOTES:**

1. Applies to 1.5" thickness and above.
2. Specific CSA or FM test results may modify this diagram.
3. This fastening pattern may be used for any 4' x 8' board products within an approved IKO roofing system.



**SHIELDBASE™ and PROTECTOBASE™ Fastening  
Pattern 18" O.C. Fasteners**

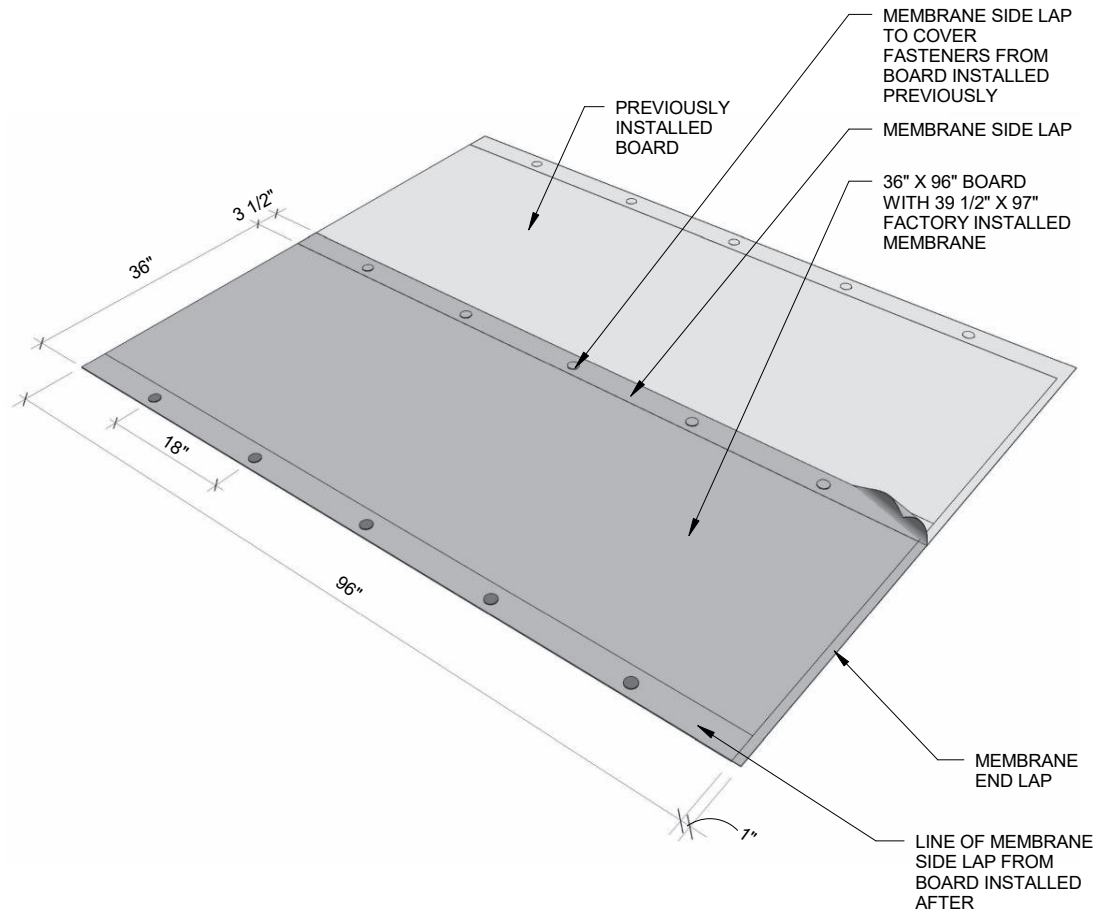

**NOTES:**

1. Specific CSA results may modify this diagram.

### SHIELDBASE™ and PROTECTOBASE™ Fastening Pattern 12" O.C Fasteners

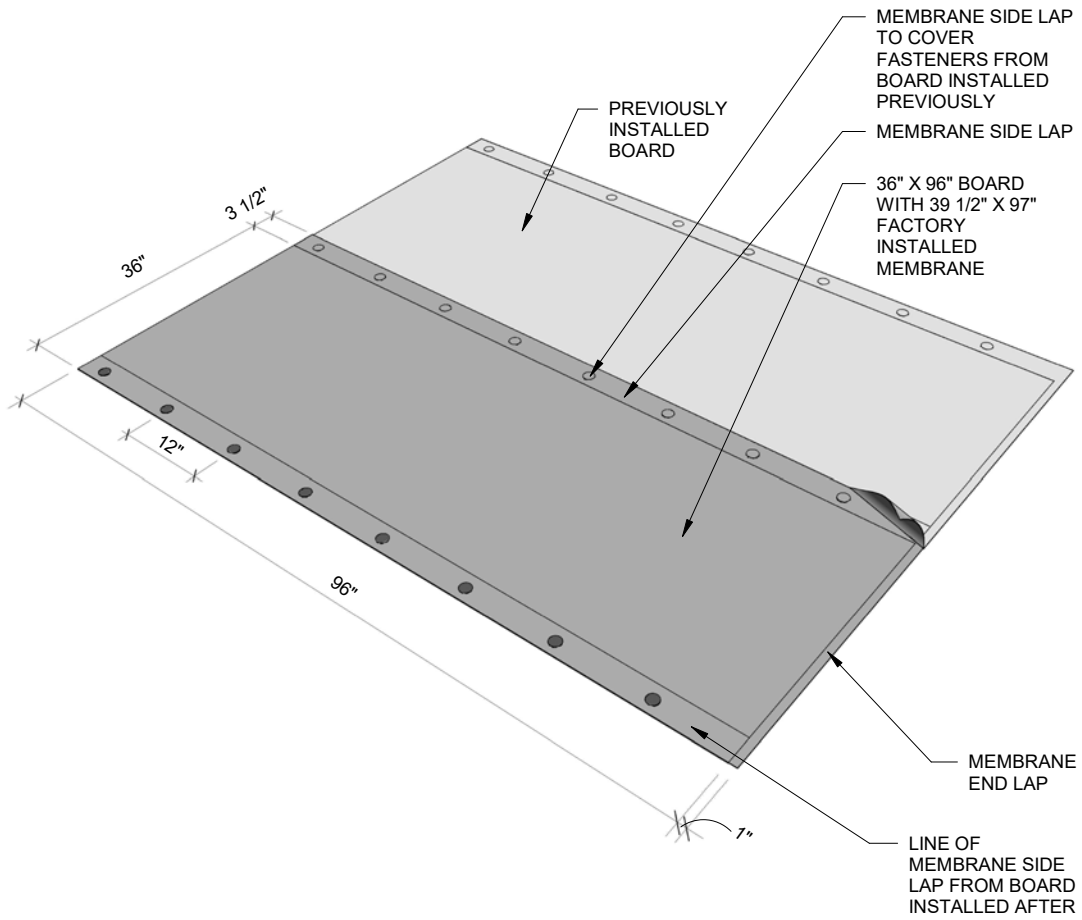



**SHIELDBASE™ and PROTECTOBASE™ Fastening Pattern**  
**6" O.C Fasteners**

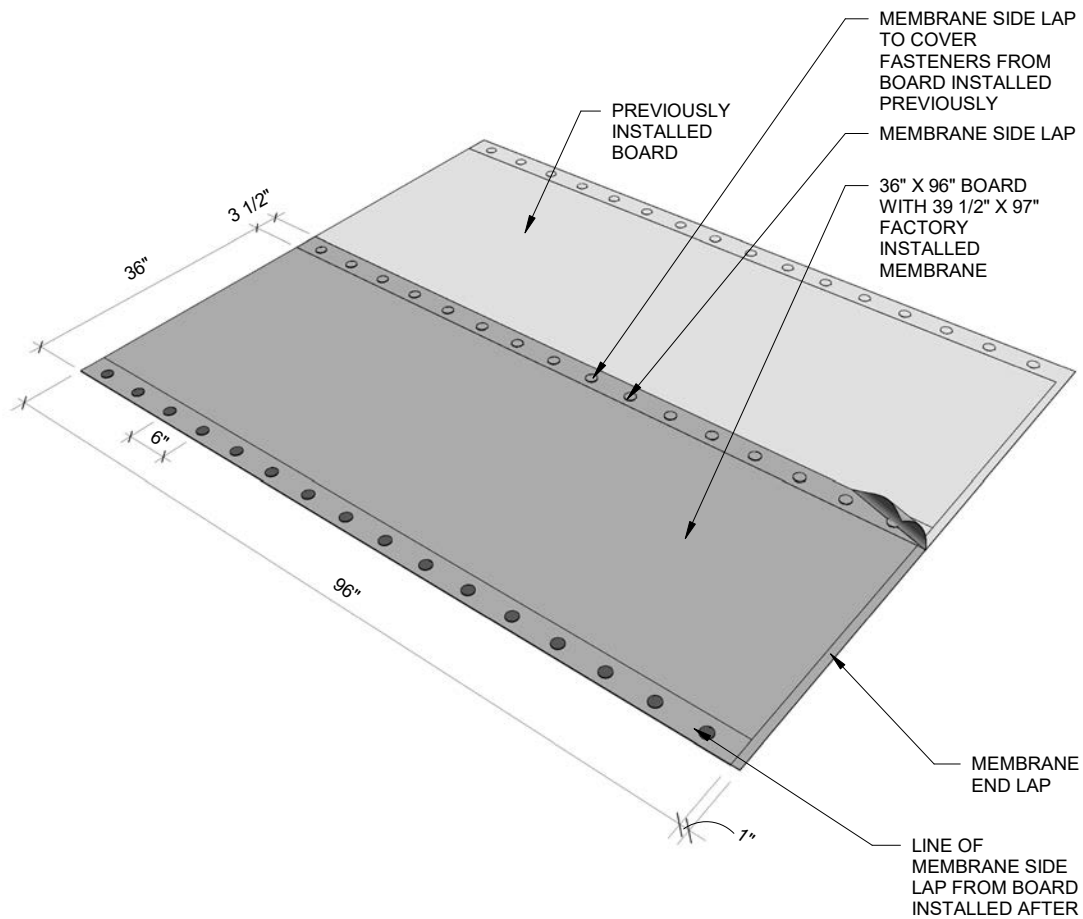

**NOTES:**

1. Specific CSA results may modify this diagram.

**SHIELDBASE™ and PROTECTOBASE™ 12" O.C Mid Seam and In-Row**

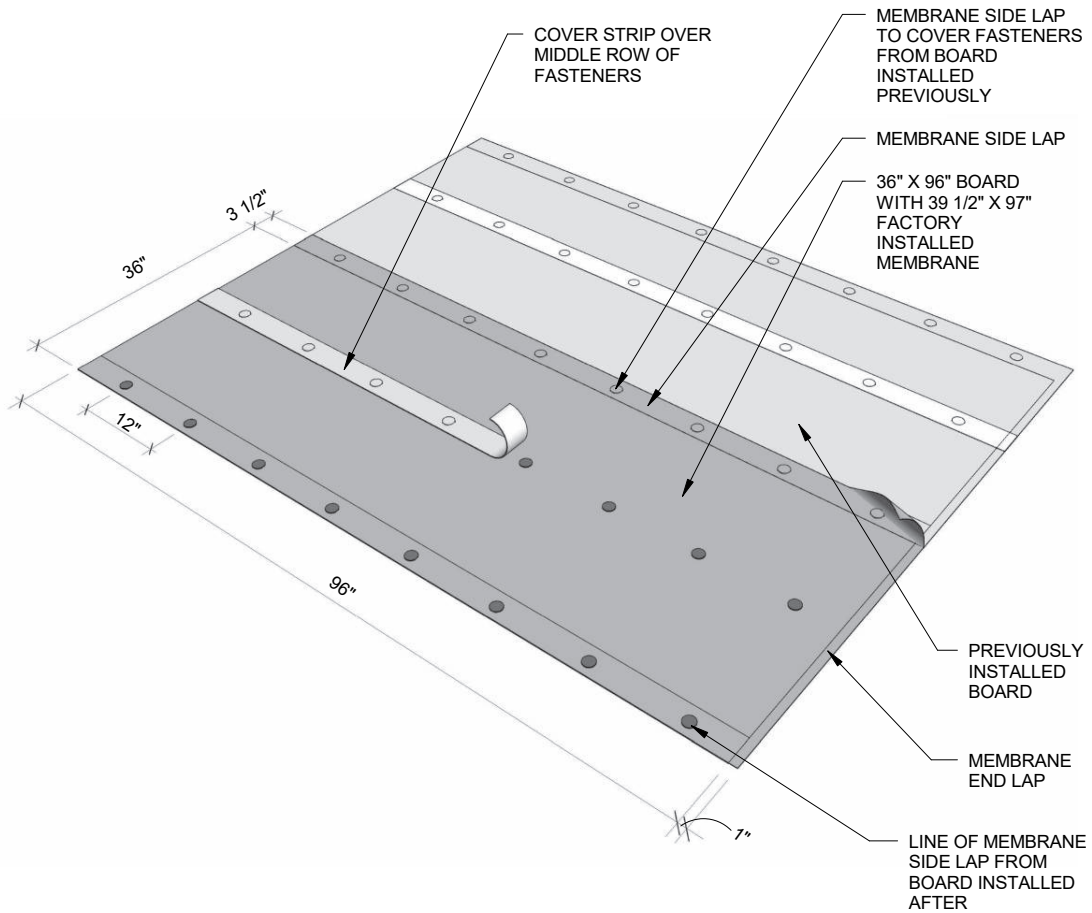

**NOTES:**

1. Specific CSA results may modify this diagram.





**PROTECTOBASE™ at Parapet Detail**

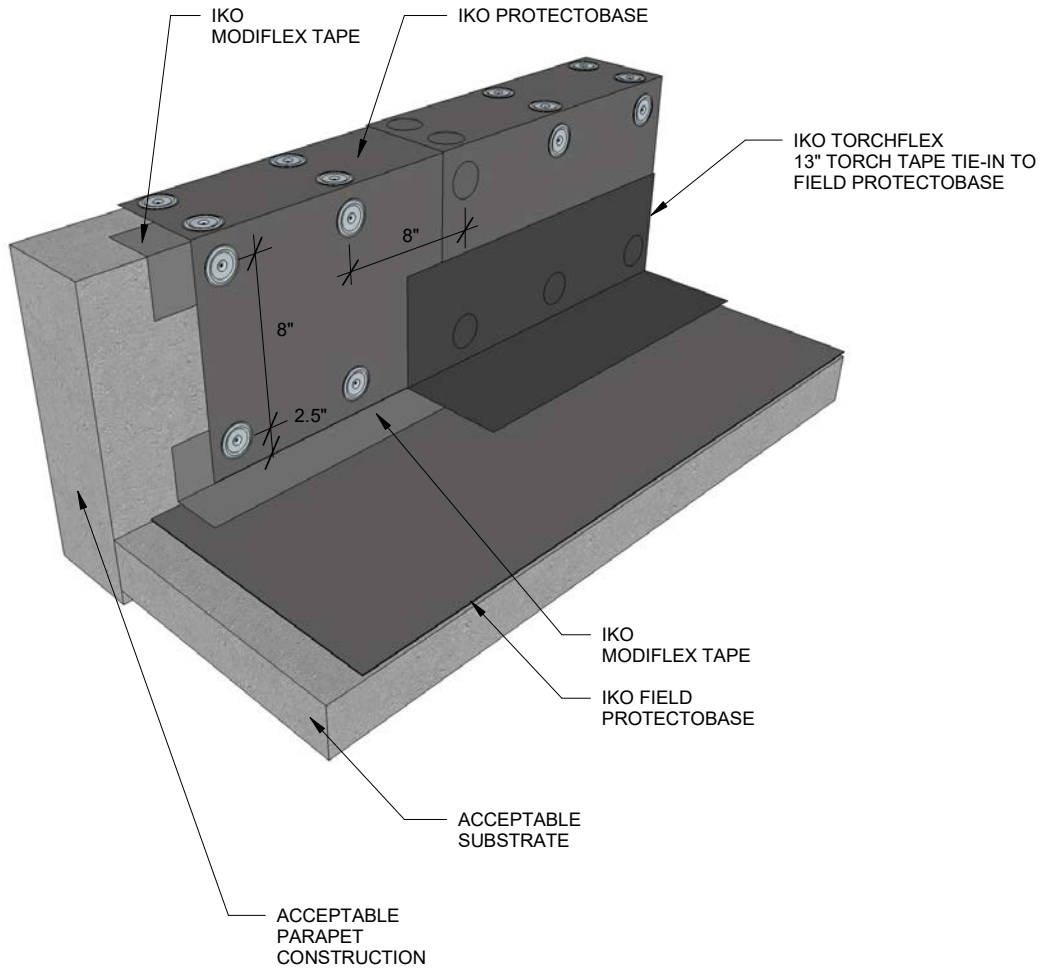

For approved mechanical fastener, contact IKO Technical Services for more information.

**Pre-Securement Pattern for Insulation under Mechanically Fastened Membrane Systems, 4'X4' board**

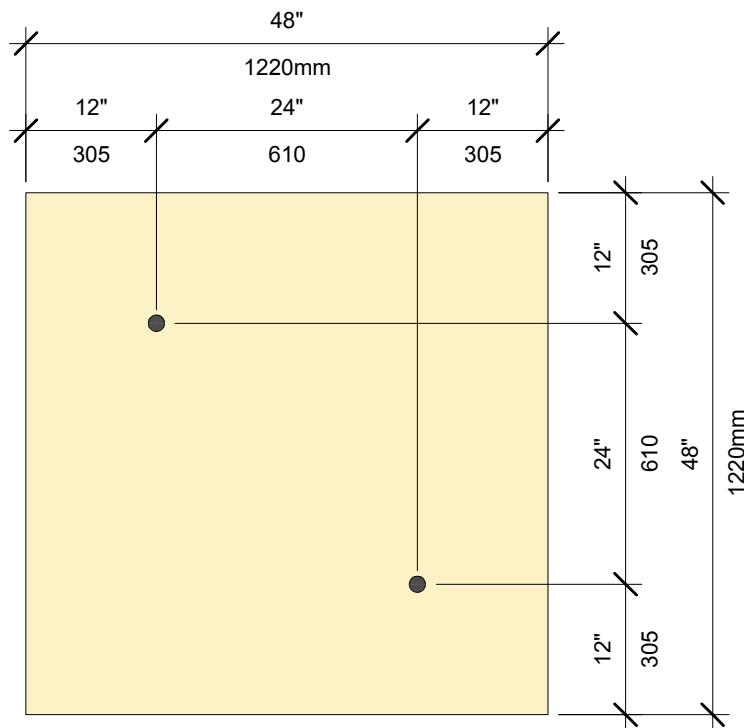



**Pre-Securement Pattern for Insulation under Mechanically Fastened Membrane Systems, 4'X8' board**

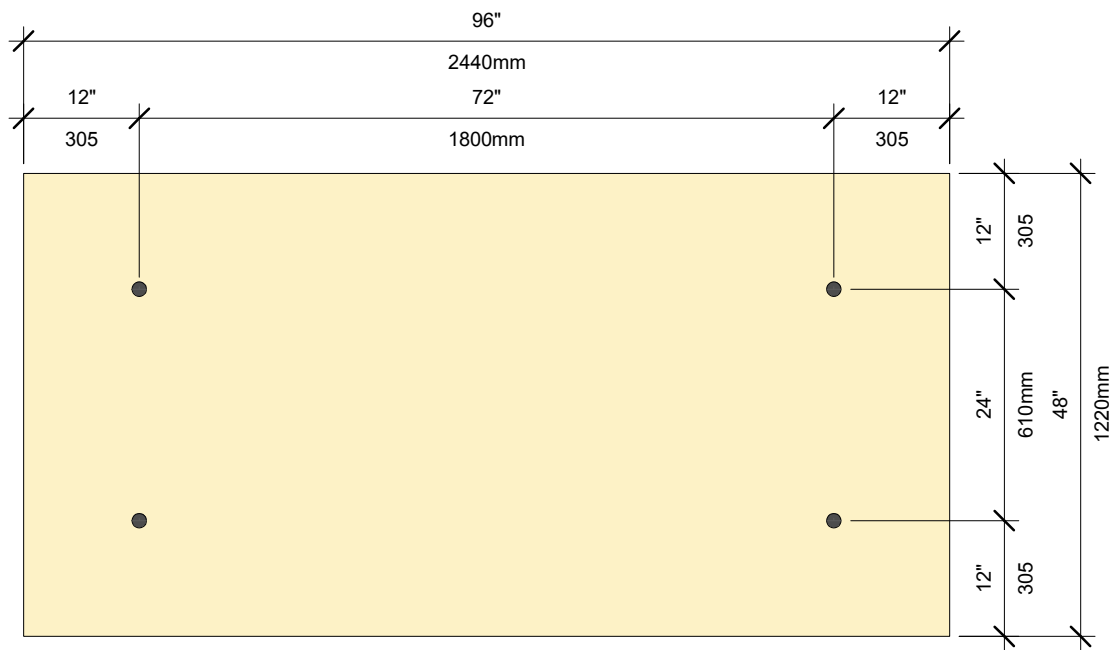

**Fastening Pattern for Mechanical Attachment  
of Base Sheet FAST-N-WELD™**

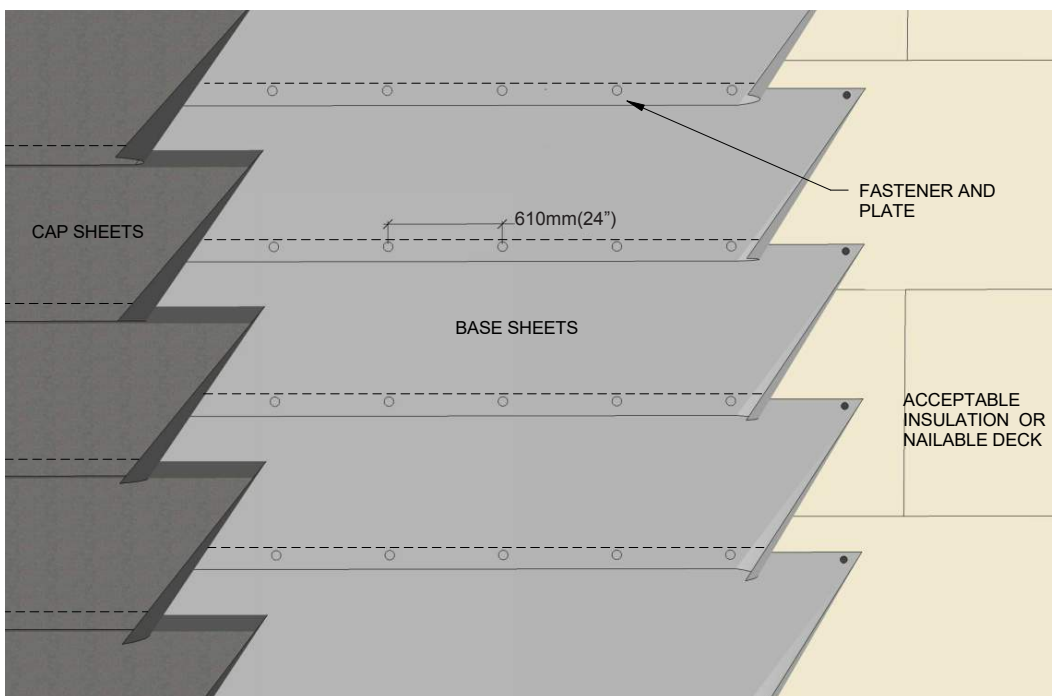

**NOTES:**

- 1. Applicable to FM rated assemblies only.



**Fastening Pattern for Mechanical Attachment of Base Sheet FAST-N-WELD™**

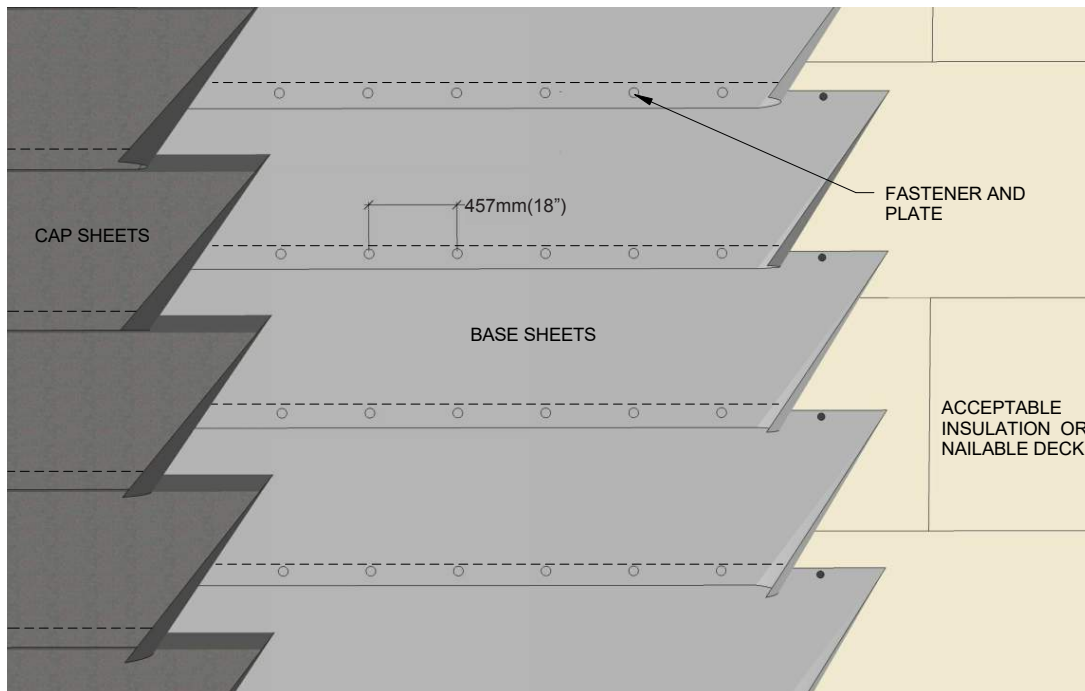

**NOTES:**

1. Applicable to CSA rated assemblies only.

**Fastening Pattern for Mechanical Attachment  
of Base Sheet FAST-N-WELD™**

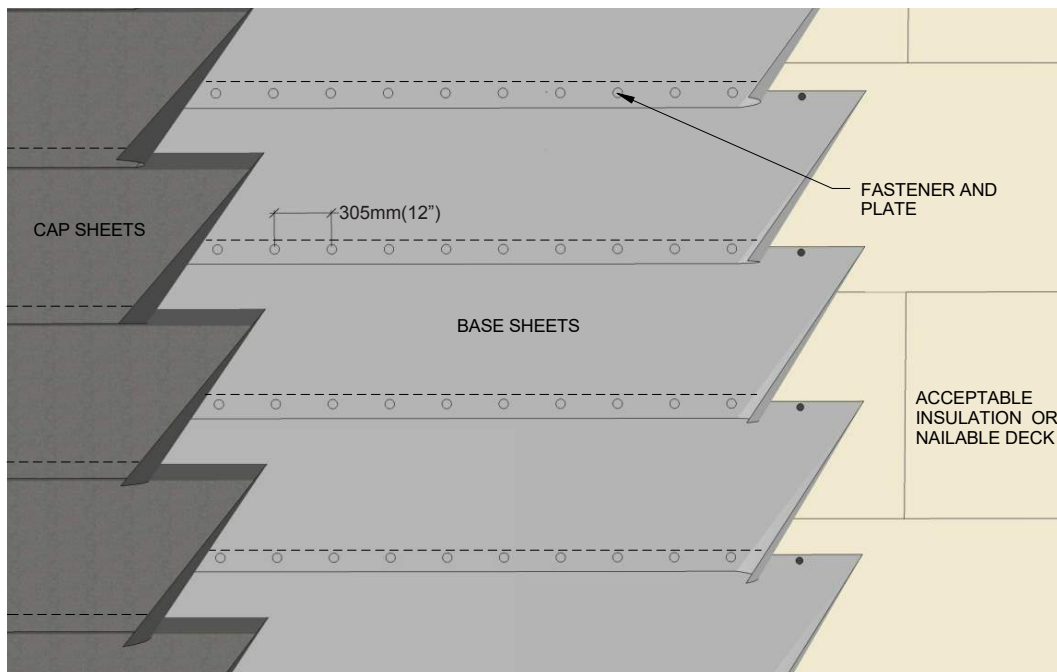

**NOTES:**

1. Applicable to CSA rated assemblies only.



**Fastening Pattern for Mechanical Attachment  
of Base Sheet FAST-N-WELD™**

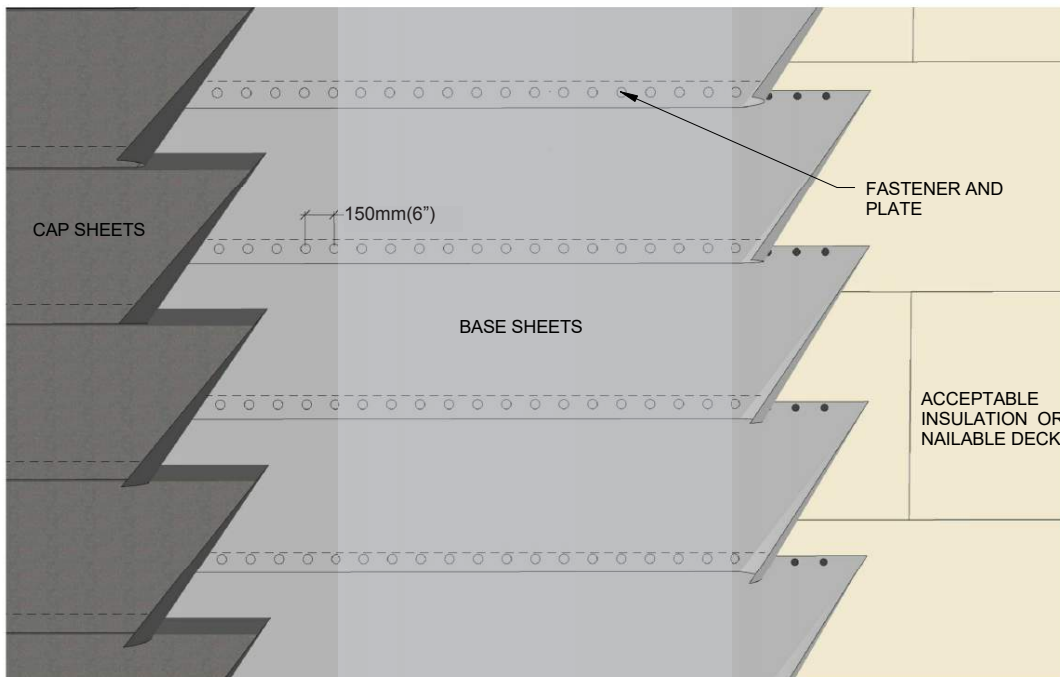

**NOTES:**

1. Applicable to CSA rated assemblies only.

**Fastening Pattern for Mechanical Attachment  
of Base Sheet FAST-N-WELD™**

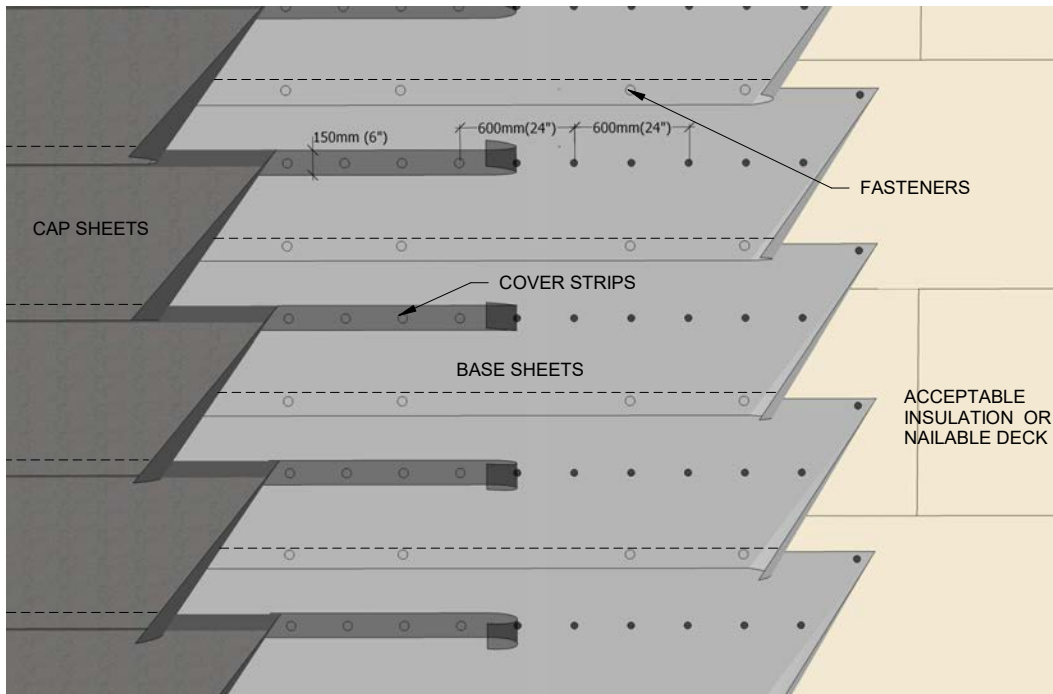

**NOTES:**

1. Perimeter Enhancement Pattern for FM rated assemblies only.





**Fastening Pattern for Mechanical Attachment of Base Sheet FAST-N-WELD™**

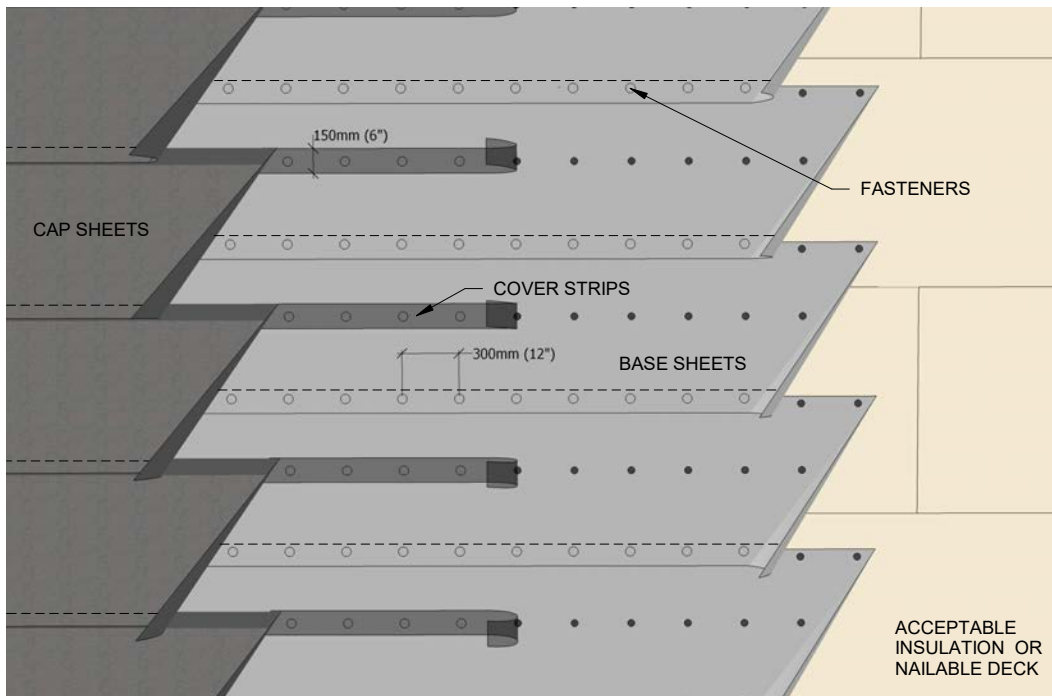

**NOTES:**

1. Applicable to CSA rated assemblies only.

## Fastening Pattern for Mechanical Attachment of Base Sheet FAST-N-WELD™

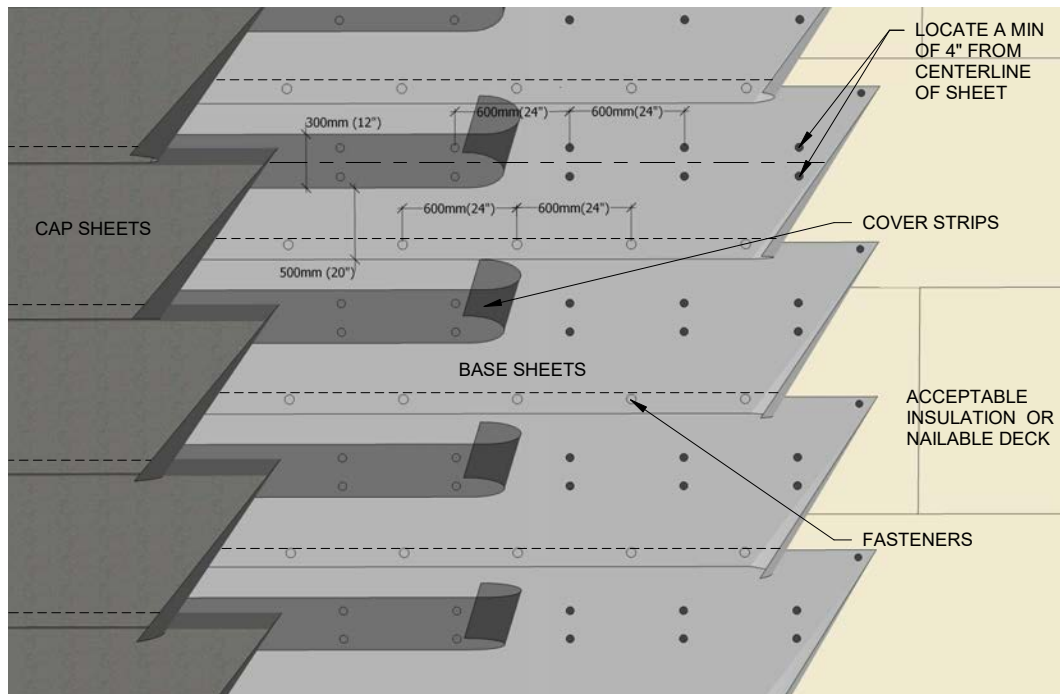

### NOTES:

1. Corner Enhancement Pattern for FM rated assemblies only.



**Fastening Pattern for Mechanical Attachment  
of Base Sheet FAST-N-WELD™**

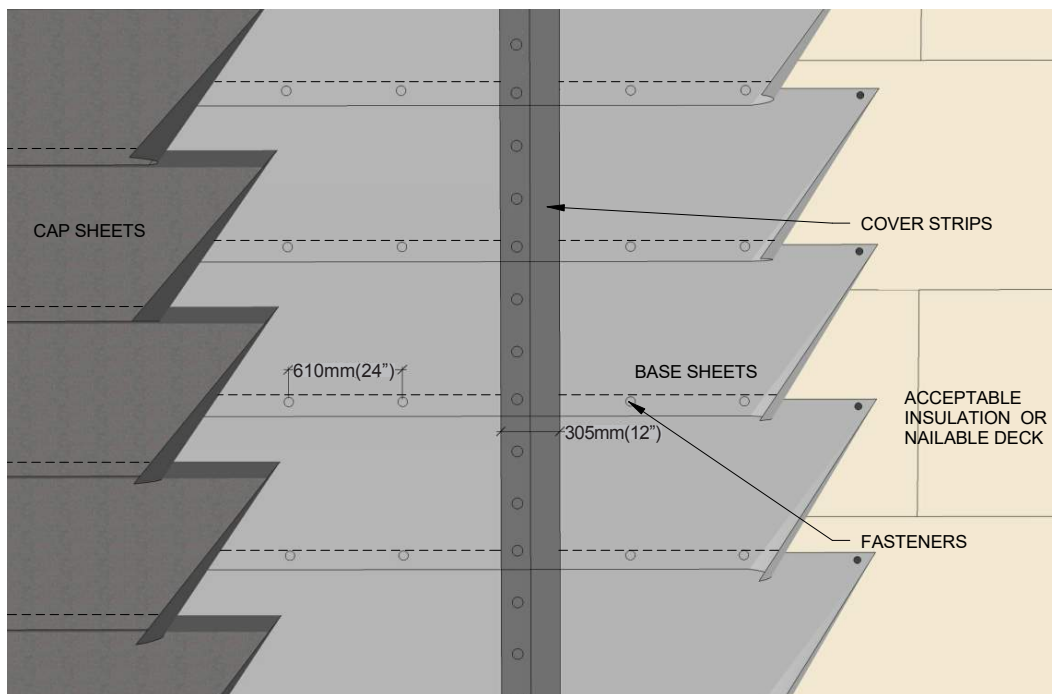

**NOTES:**

1. Applicable to both FM and CSA rated assemblies.
2. Soldering of the Fast-N-Stick Base Sheet is an acceptable practice.