

1 - FIELD
2 - PERIMETER
3 - CORNERS (2a)

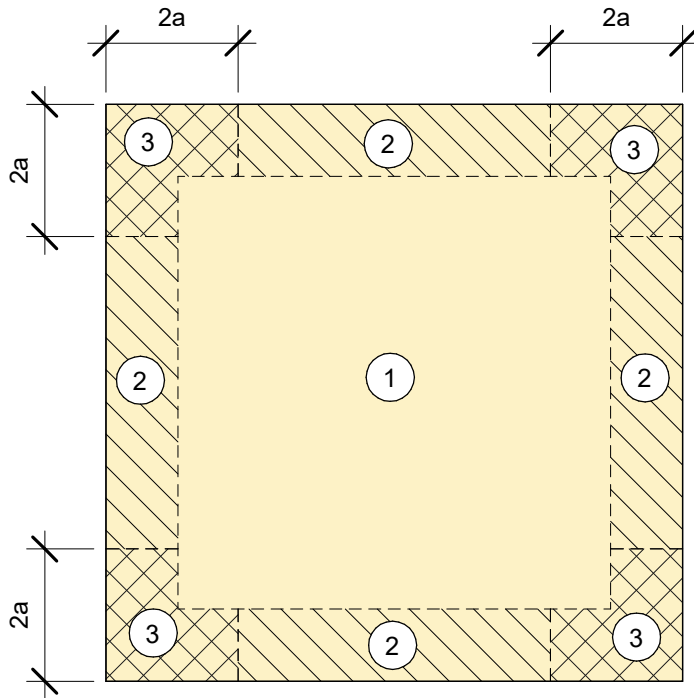

NOTES:

1. FIELD is the central part of the roof.
2. PERIMETER width is 10% of the shortest plan side but never less than 3 feet (1 m).
3. CORNERS (2a) are the areas of intersection of two Perimeter areas, extended twice the width of the PERIMETER area along the edge of the roof.
4. Per ASCE-7, CORNERS may be treated as PERIMETER if a continuous parapet of minimum 36" (1 m) height above the roof deck is present on all sides of the roof.
5. If any portion of an insulation board lies within a PERIMETER or CORNER, fastening of the entire board must be enhanced.

**ROOF ZONES,
 ROOF HEIGHT GREATER THAN 60'**

RZ-2



COMMERCIAL

Specify *with Confidence.*