

**NOTES:**

1. For Mechanically Attached Systems, install min. four (4) InnoviFast TPO AP or HD Seam Plates and Fasteners to secure the roof membrane at the base of the pipe (see small drawing).
2. Heat weld boot to membrane, min. 1-1/2" width weld, at perimeter of boot.
3. Add a continuous bead of InnoviSeal Water Stop Mastic on pipe behind boot at clamp location.
4. If installing boot over a membrane and membrane seam with InnoviFlash TPO Joint Covers.
5. Apply a continuous bead of InnoviSeal TPO Edge Sealant at the base edge of the flashing and at all cut edges.

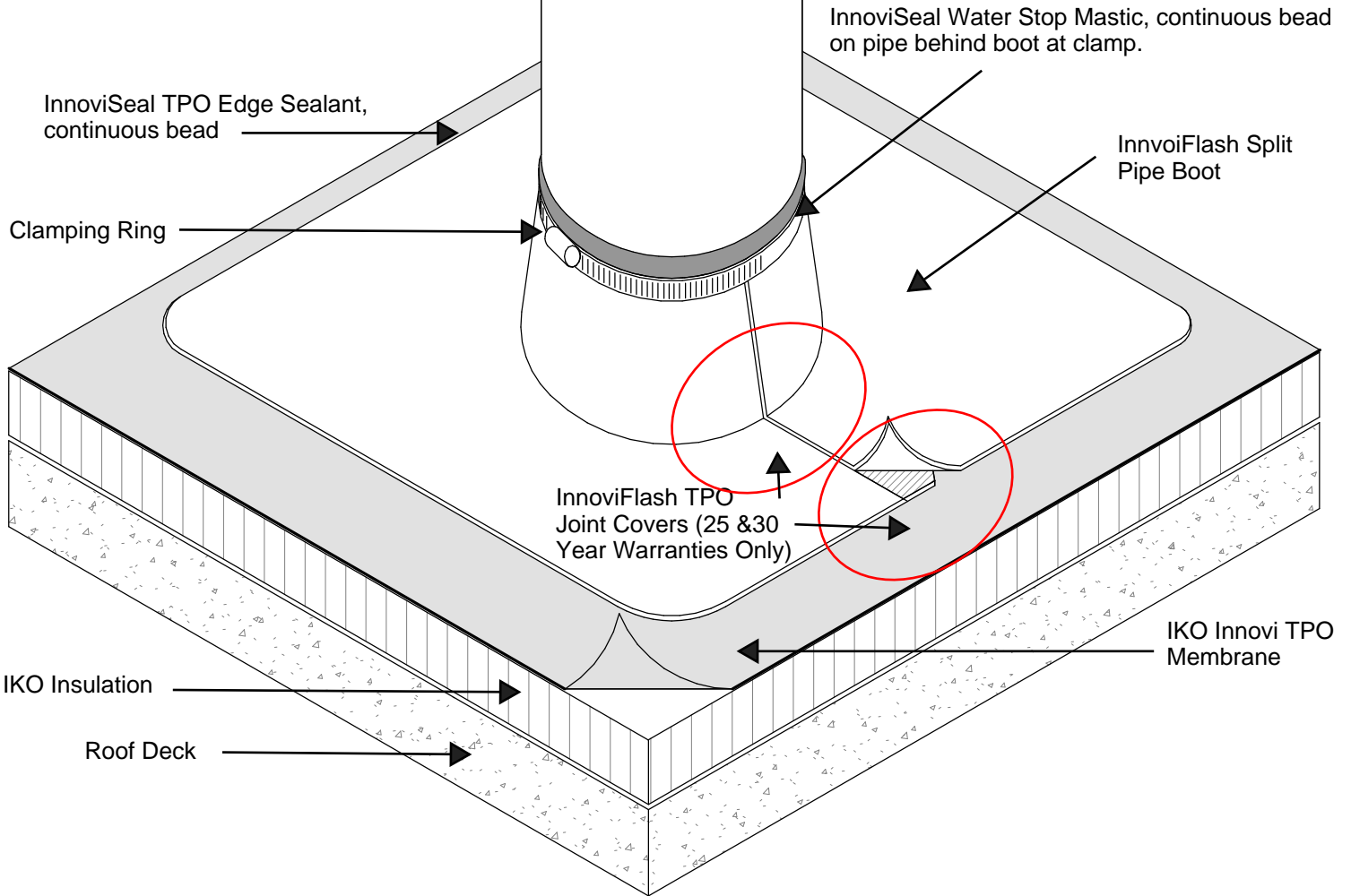
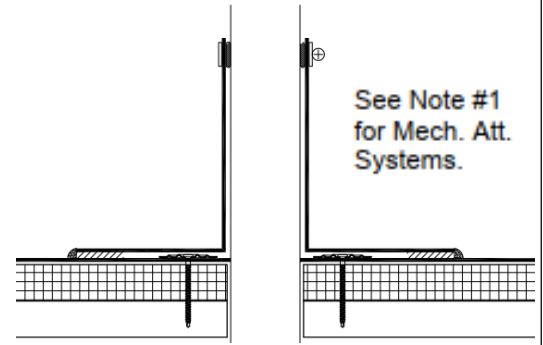

**WARRANTY NOTE: THIS DETAIL IS ACCEPTABLE FOR UP TO 20 YEAR WARRANTIES ONLY. FOR 25-30 YEAR WARRANTIES, INNOVIFLASH TPO JOINT COVERS MUST BE INSTALLED AT THE WELD AT THE ANGLE CHANGE, AND WHERE THE BASE OF THE FLASHING MEETS WITH THE MEMBRANE.**

**SPLIT PIPE BOOT**

**PF-2**